



FRU VEBER

VESSEL DESCRIPTION

Class "A" Guard vessel

OVERVIEW

LOA: 21.23 m
Breadth: 5.16 m
Draught: 1.7 m
Tonnage: 57 GT / 17NT
Displacement: 47 ton
IMO: N/A
Call sign: OWOV2
Hull: Aluminium
Built 1984, Hull 331 Djupviks Varv, Sweden
Un-classed, approved by Danish Maritime Authorities
Home port: Svendborg
Range: 100 nm off the coast (summer) / 50 nm off the coast (winter), within A2
Service speed/Consumption: 20 knots on abt 340 l/hour
Max speed: 25 knots
Diesel oil: Abt 7 cbm
Luboil: 0.19 cbm
Fresh water: 0.7 cbm, watermaker installed

SAFETY EQUIPMENT

Liferafts: DSB 2 x 16 pax A package
Fire-alarm central: Servo Fighter
EPIRB:Fitted
SART: Fitted
Anchor winch: Rapp Hydema
Dacon Scoop fitted

CAPACITIES

Fuel: abt. 7000 ltr
Lub oil: abt. 190 ltr
Fresh Water: abt. 700 ltr (water maker fitted)

ACCOMODATION

Cabins: 4 single cabins for crew only
TV & internet TV lounge, internet in all cabins and public areas
There is no room for client reps on board
Fru Veber

MAIN AND AUXILARY MACHINERY

Main engines: 2 x Cummins, KTA-38M.
Power: 2 x 765 kW at 1950 rpm
Gear: ZF, BW 255 reduction 2.03
Auxiliary engines: 2 x G&M Marine Dieselite, 40 MDP4-57R, 36.7 kvA, 220/380.

MACHINE EQUIPMENT

Hydro prime pump: Grundfoss Robota GAE 0.5
Fire pump: Desmi S70-05-220 / A09, 650 l/m
Main engine Bilge pump: ASEA MT90S Desmi S70-05-220/ A09
Main engine Transformer: TPK 39.4 V
Compressor: ABAC B1800FL, 2hp, 240 l/m
Steering gear: Seffle HL 1035R

OTHER INFORMATION

Deck crane: Hiab ZO Sea Crane, max 2.4 meter ton
RIB Boat: Optional, Avion
An ISM light system with MLC is implemented
Vessel holds the German Certificate of Equivalence.

NAVIGATION AND COMMUNICATION EQUIPMENT

ECDIS: Transas NaviSailor 3000
Radar: Furuno, FR-2115 ARPA + Furuno FR-2115
Auto pilot: Robertson, AP45
Depth sounder: Target 2
Navtex: Furuno, NX-500
VHF: Sailor, RT4822 DSC
InCAPAterkom: Amplidan, Commander 1500
Wind instrument: Brookes & Gatehouse

VESSEL CONTACT INFO

Phone: + 45 22 73 18 55
E-mail: fruveber@shipmanagement.dk

SPECIFICATONS

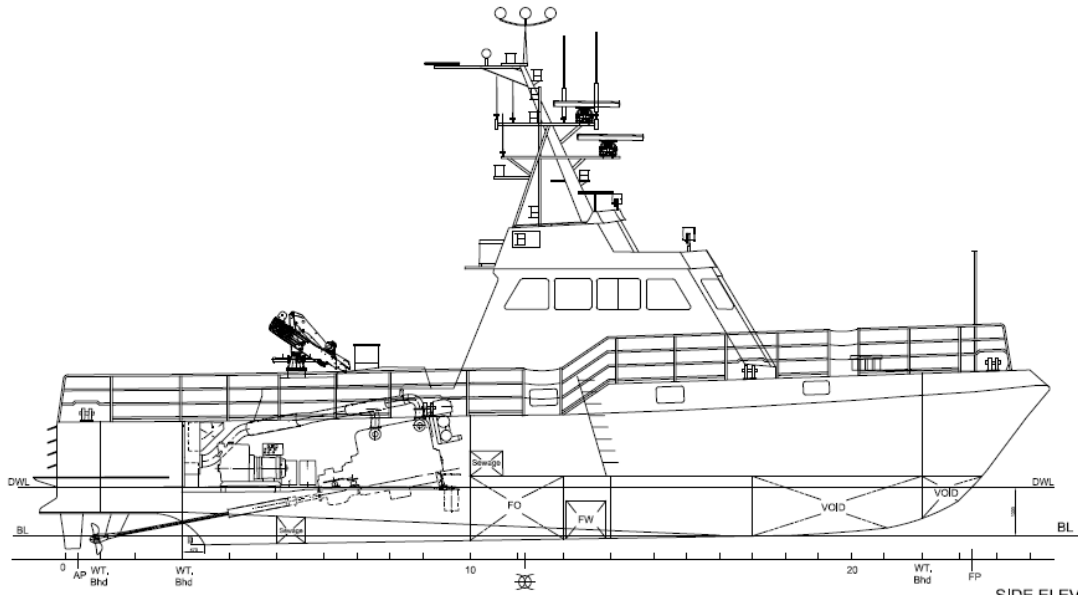

SIDE ELEVATION

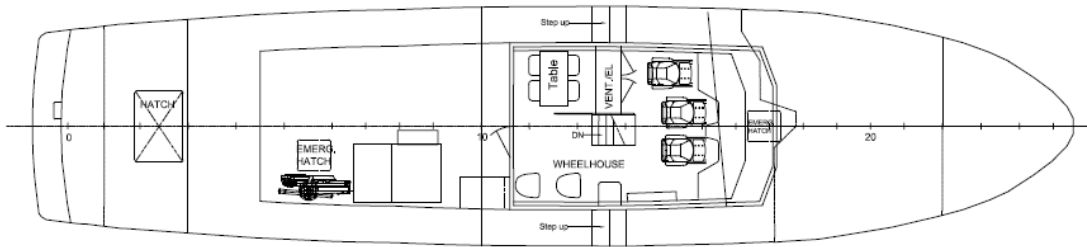

MAIN DECK

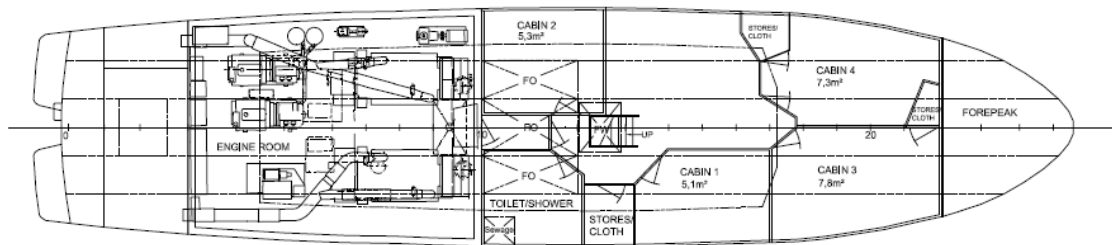

BELOW MAIN DECK